

NICOLAI - GEOMETRON G1 torque table				
Nr.	Part	Bolt dimension in mm	Required torque in Nm	State
1	Bearing cap/ Lagerdeckel	M12, Pitch 1.0	12.5 - 15	Thread lock - medium strength
2	Shock bolts/ Dämpferschrauben	M8x40	16.5 - 17.5	Assembly grease
3	Thru axle/ Steckachse	M12, Pitch 1.75	10 - 12	Assembly grease
4	Seat stay Mutator bolts/ Mutatoren Schrauben - Druckstrebe	M5x40/ M5x45	8 - 8.5	Thread lock - medium strength
5	Seat stay bolt/ Druckstreben Schraube	M5x40	8 - 8.5	Thread lock - medium strength
6	Mech hanger bolt/ RADO Schraube	M5x12	7 - 8	Dry
7	Mech hanger bolt CABLE GUIDE/ RADO Schraube ZUGFÜHRUNG	M5x14	4 - 5	Dry
8	33/41/47mm Swingarm Mutator bolt/ Mutatoren Schraube - Schwinge	M6x18	10 - 12	Dry

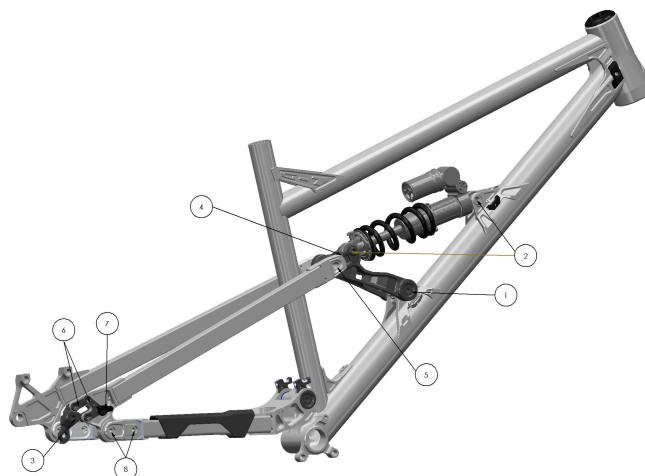

Nr.	Part	Bolt dimension in mm	Required torque in Nm	State
9	54mm swingarm Mutator bolts	M6x22 & M6x25	10 - 12	Dry
10	54mm swingarm Mutator pre-load bolt	M5x14	4 - 5	Thread lock - medium strength

54mm swingarm Mutator assembly:

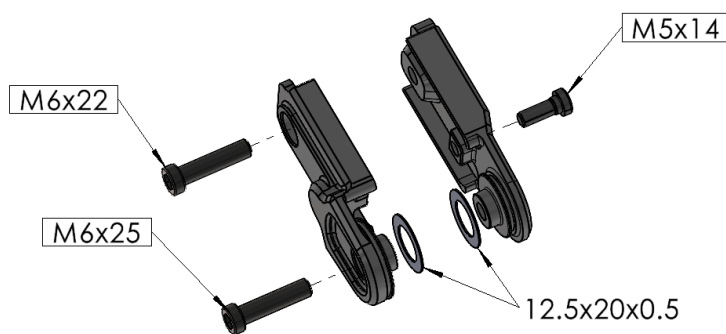

Torque pattern:
1st: M6x25mm
2nd: M6x22mm
3rd: M5x14mm

Please always use 0.5mm shims.  
They protect the bearing seat.

**Info: Chain length and chain stay Mutator setup**  
Increasing your chain stay length via the Mutators by two or more steps will require at least one more outer and one more inner chain link (e.g. from 33mm to 47mm)

If you have any further questions please send us an email or give us a call

Geometron Bikes Ltd  
Wyastone Business Park  
Monmouth  
NP25 3SR  
UK

Phone: 0044 (0)1600 887500  
Email: info@geometronbikes.co.uk

27/09/2023 - rev. 2

